

The image displays two architectural drawings of a building facade. The left drawing is a perspective view showing a multi-story building with a grid of windows. The right drawing is a section view, showing the internal structure and the placement of the facade elements. The section view includes a central entrance area with a pediment and a small window above it. The roofline is indicated by a dashed line. The drawings are rendered in a technical, line-art style.

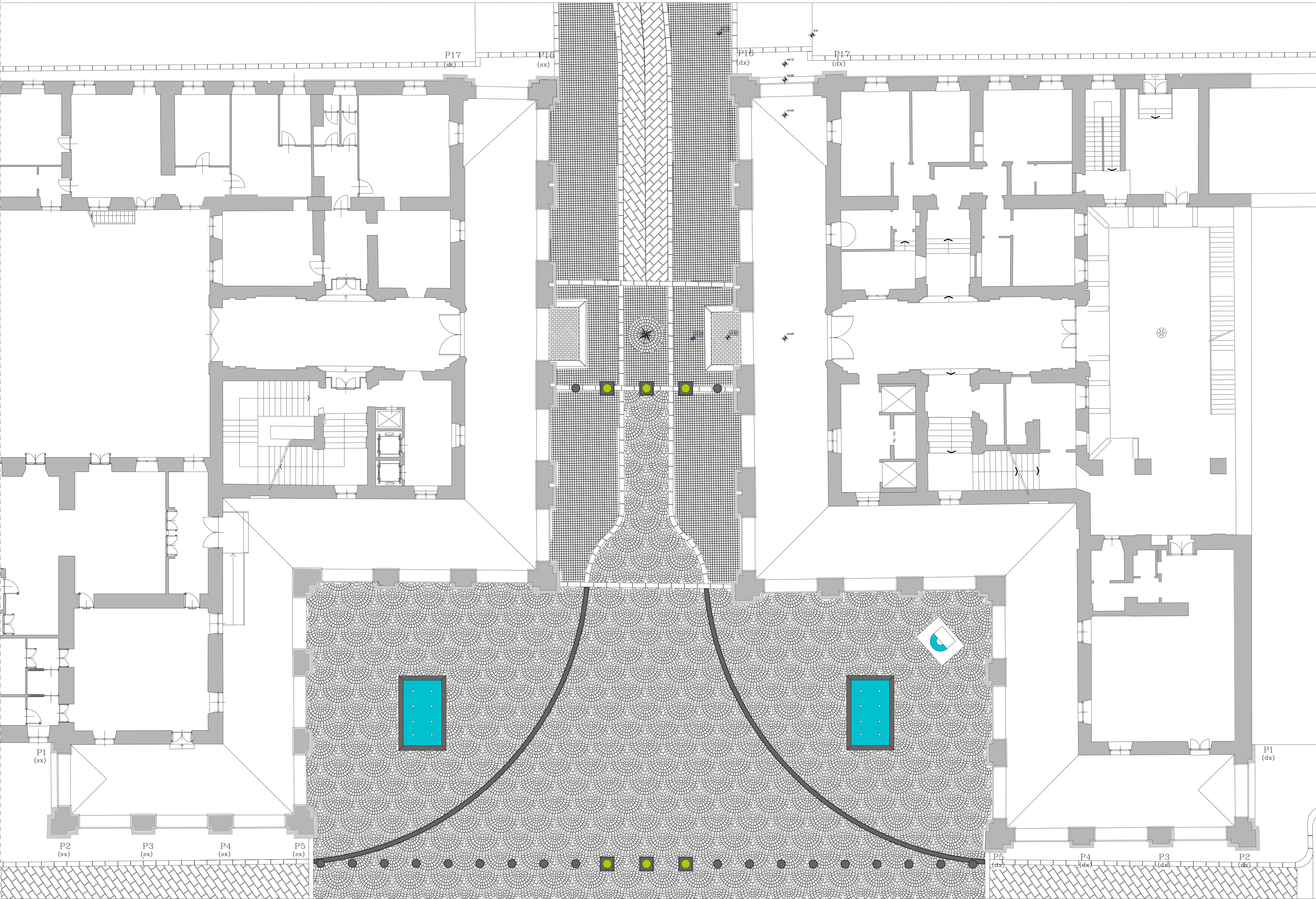

Pianta di Palazzo San Celsio

The image displays two architectural drawings of the Palazzo del Comune in Palermo. The left drawing is a detailed elevation of the facade, showing a symmetrical arrangement of windows and arches. The facade is divided into three main sections: a central section with a large archway and two side sections with smaller arches. The windows are arranged in a regular pattern, and the facade is topped by a series of small, square windows. The right drawing is a section view of the building, showing the internal structure and the arrangement of the rooms. The section is divided into three main parts: a central part with a large hall and two side parts with smaller rooms. The drawing shows the structural elements of the building, including the walls, floors, and roof.